

7

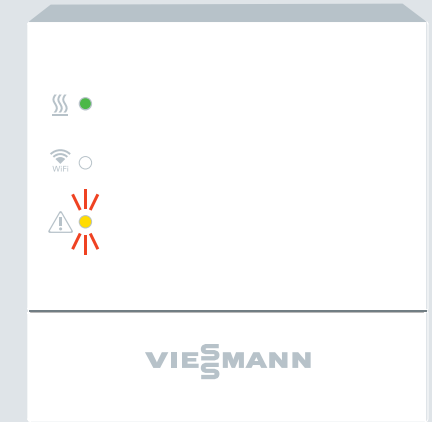

8



9

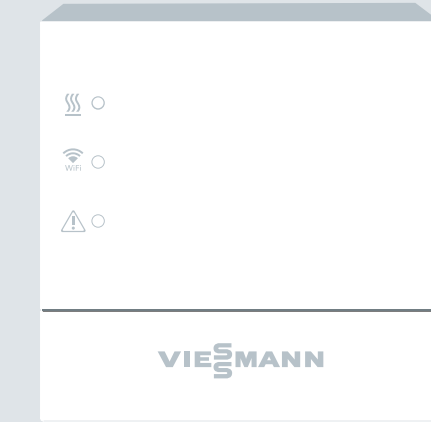
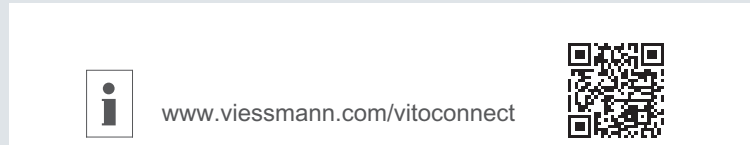

**VITOCONNECT**

1

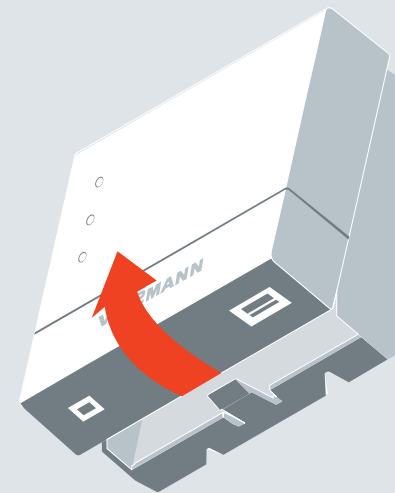

2

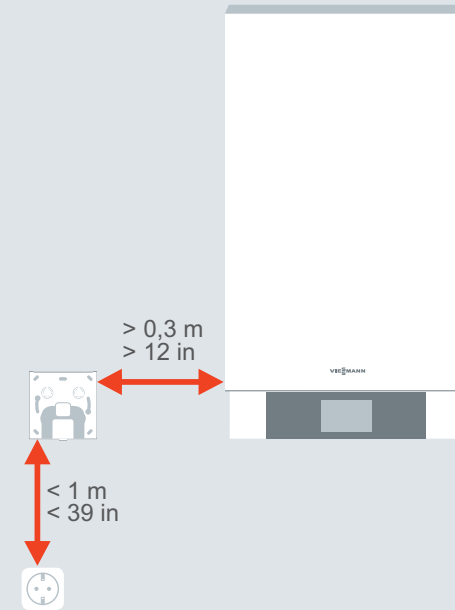

3

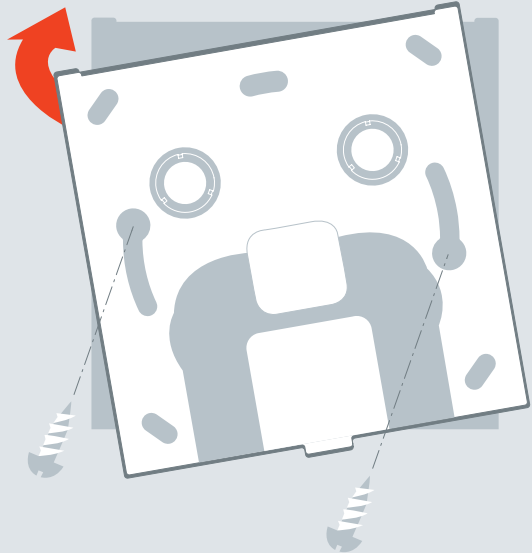

4

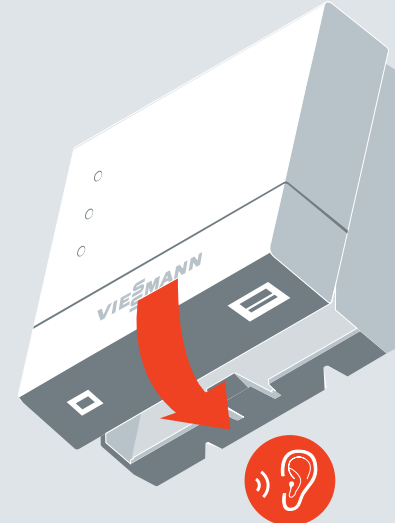

5

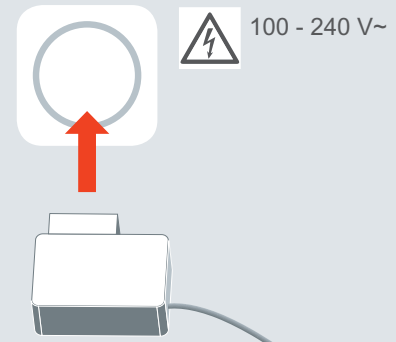

6

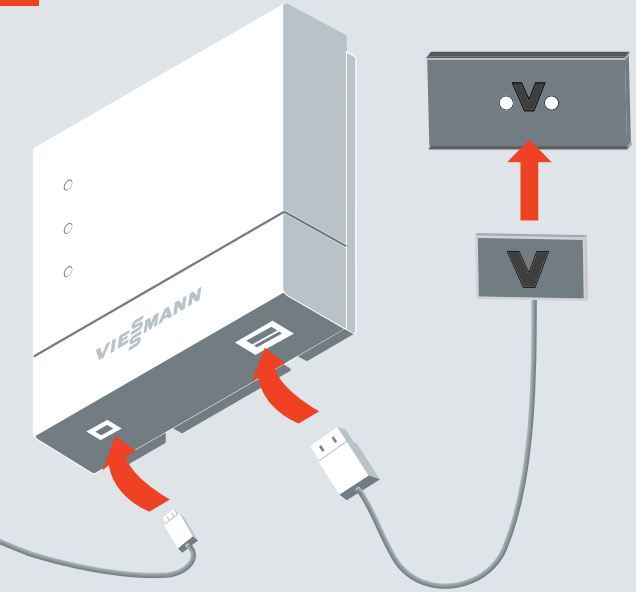

7

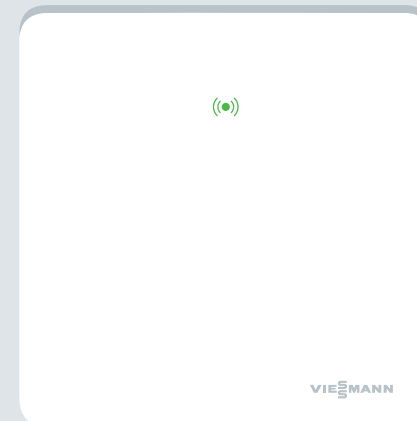

8



ViCare



[www.viessmann.com/vitococonnect](http://www.viessmann.com/vitococonnect)

9

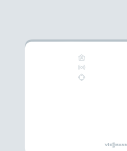
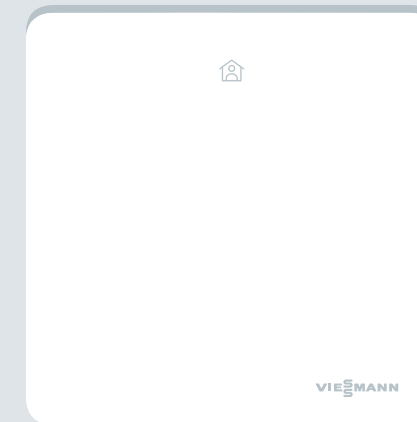

f: 2400,0 - 2483,5 MHz  
P<sub>max</sub>: 0,1 W (e.i.r.p.)

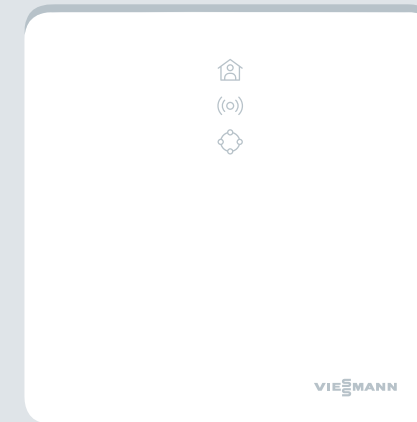

**VITOCOCONNECT**

1

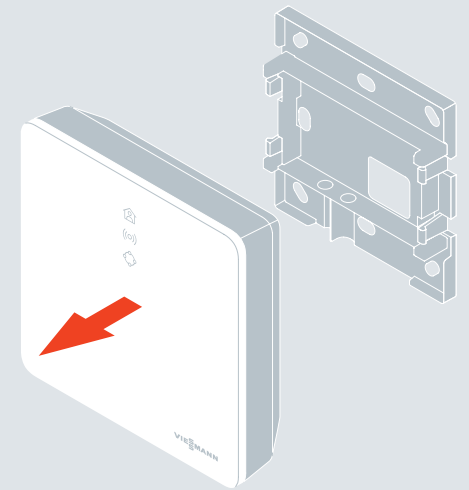

2

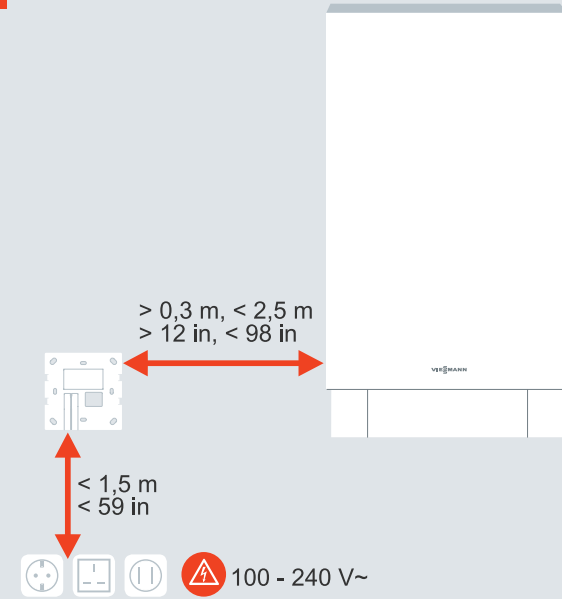

3

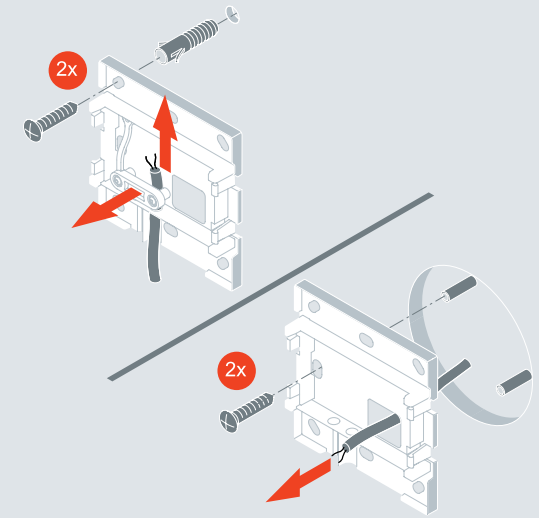

4

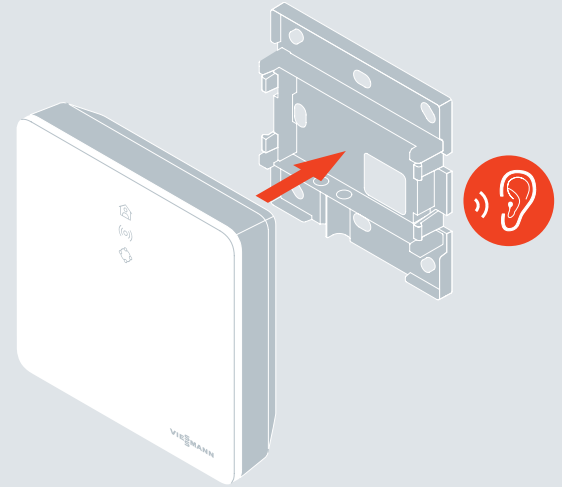

5

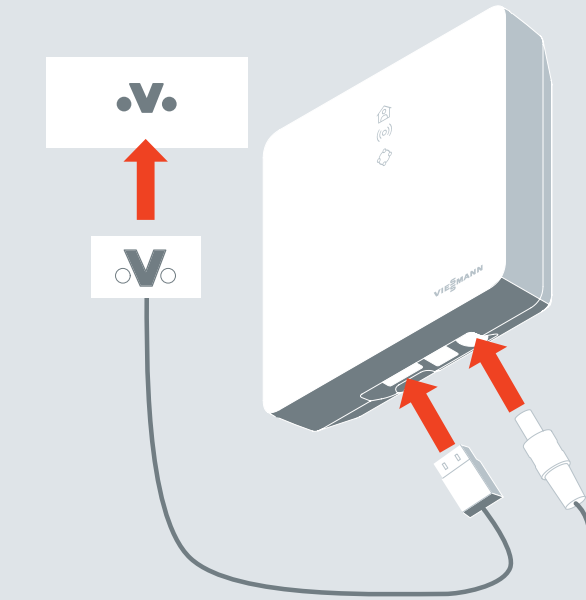

6

